

Vertical fuselage, bottom part

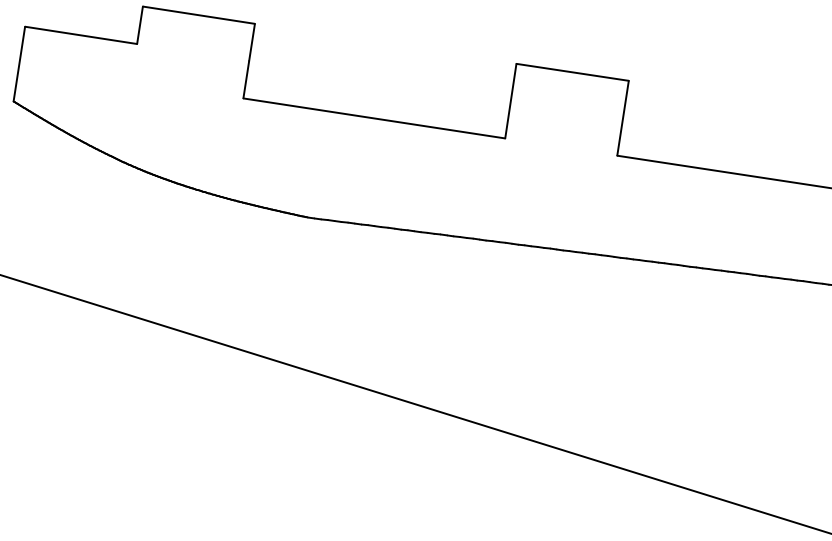

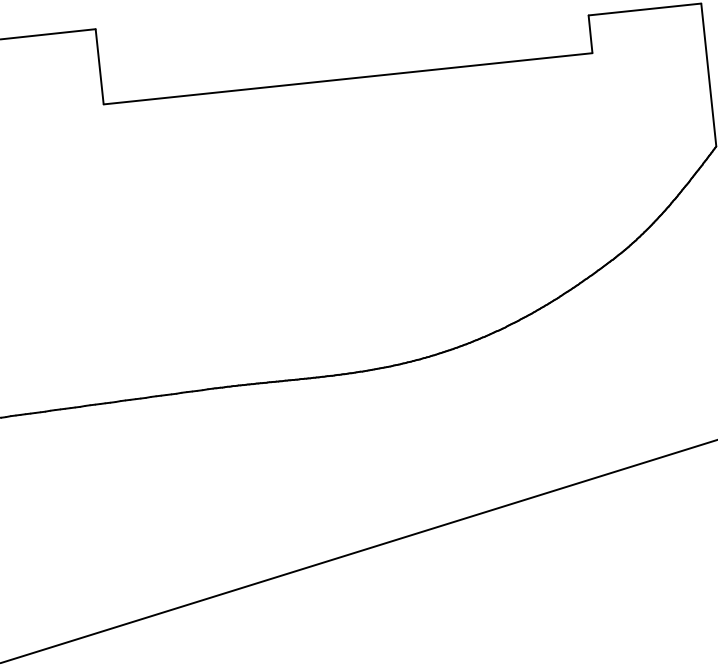

Vertical fuselage, top part

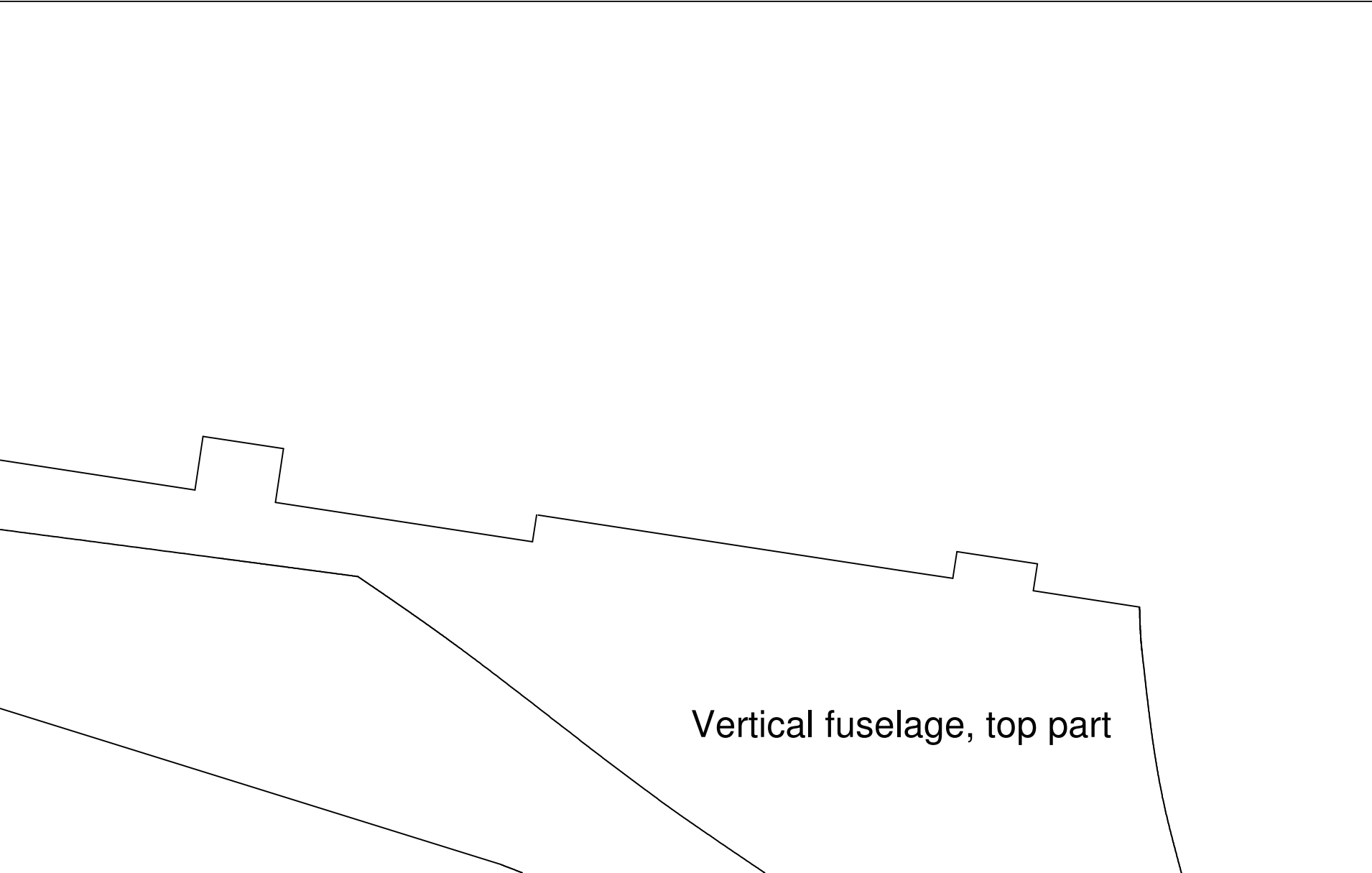
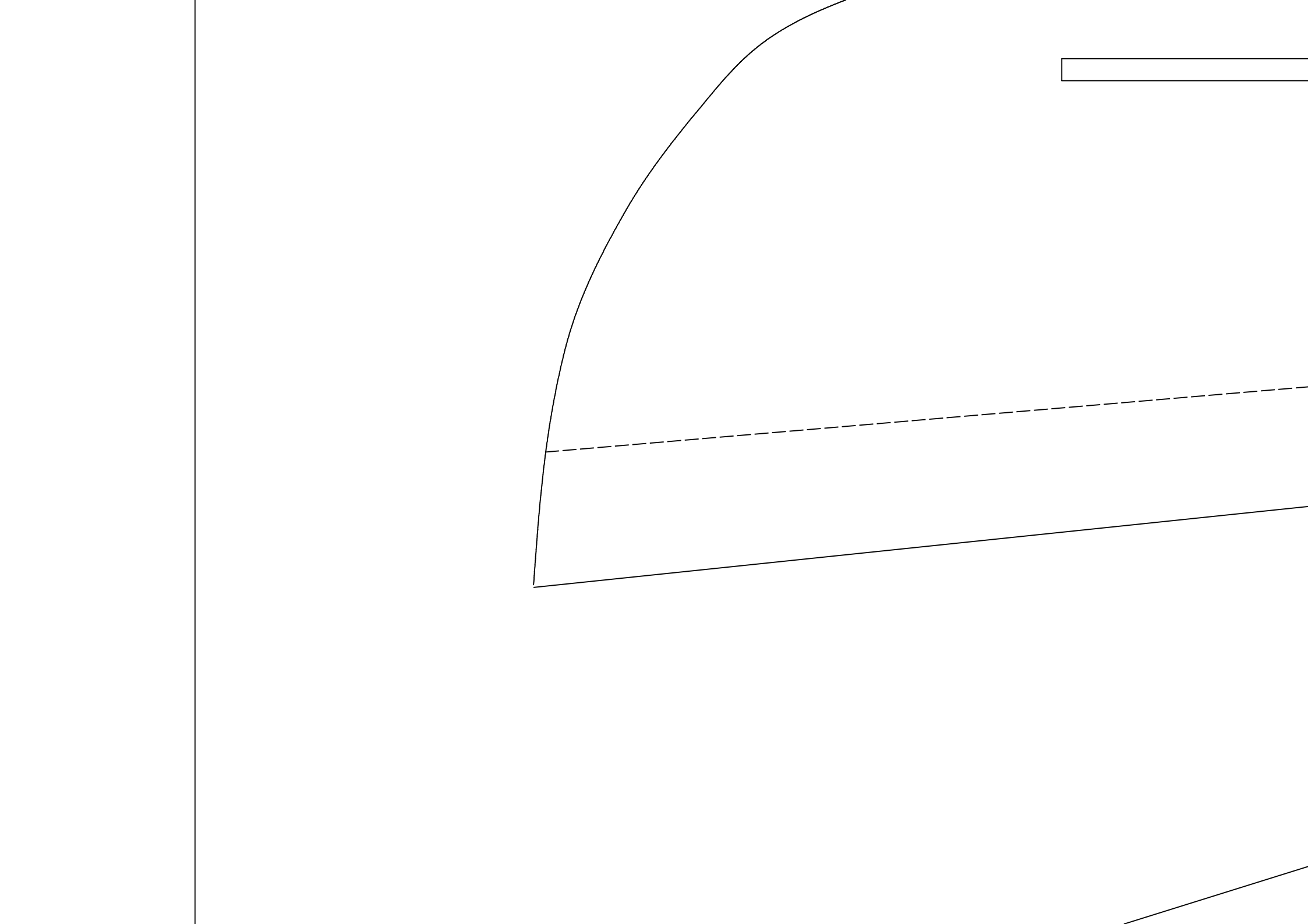

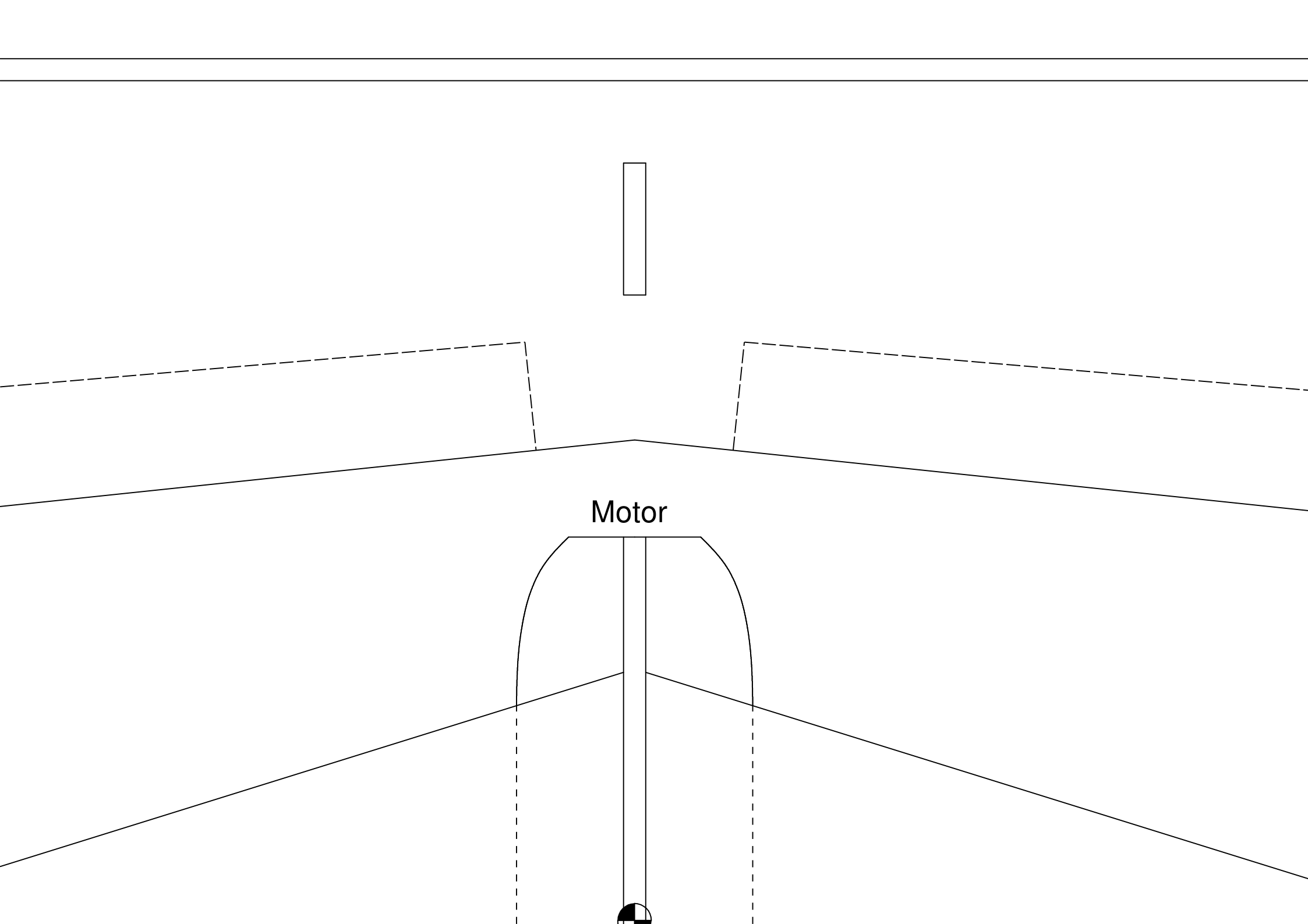

Motor

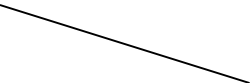
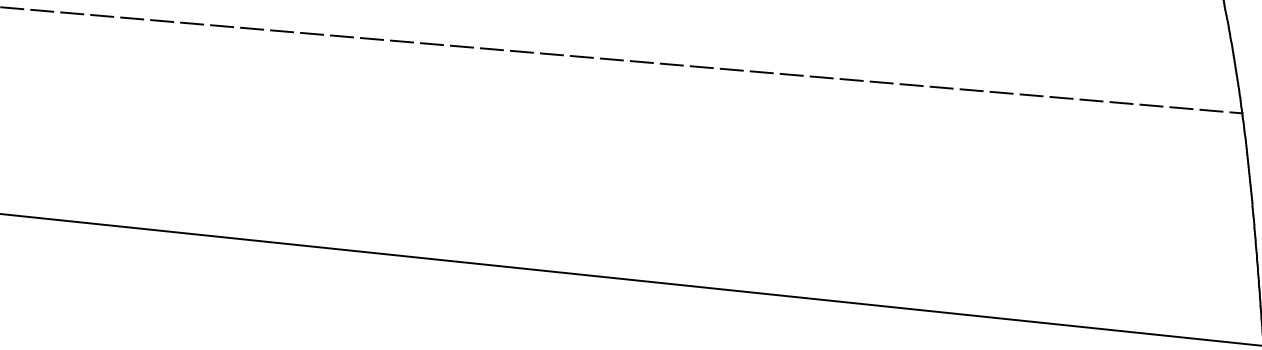
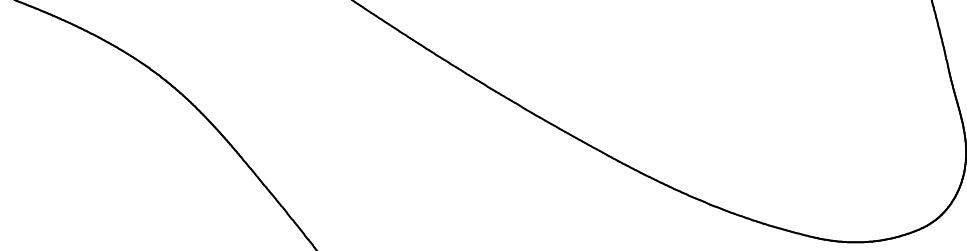
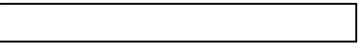

To

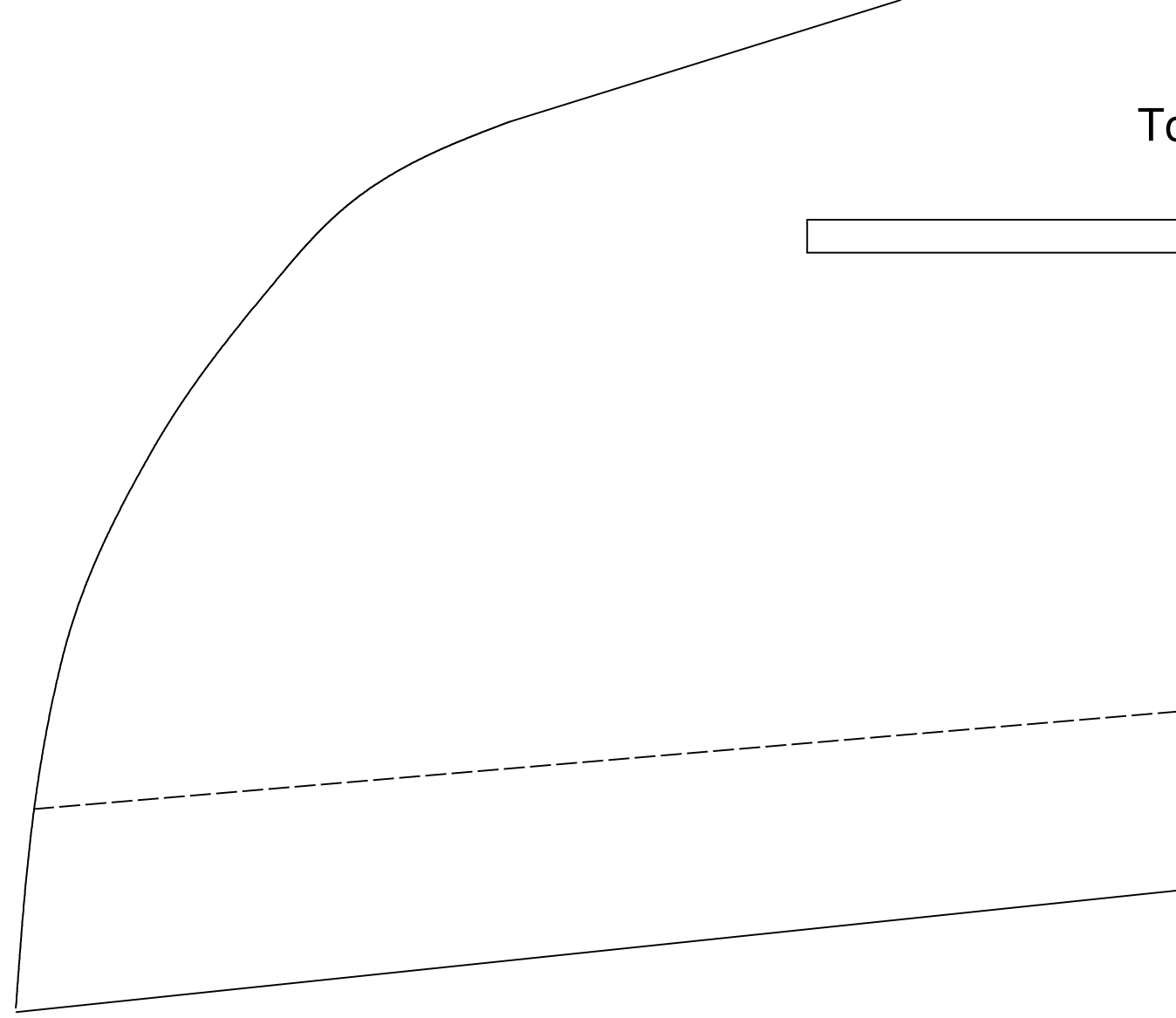
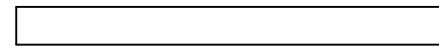

Top view and suggested layout

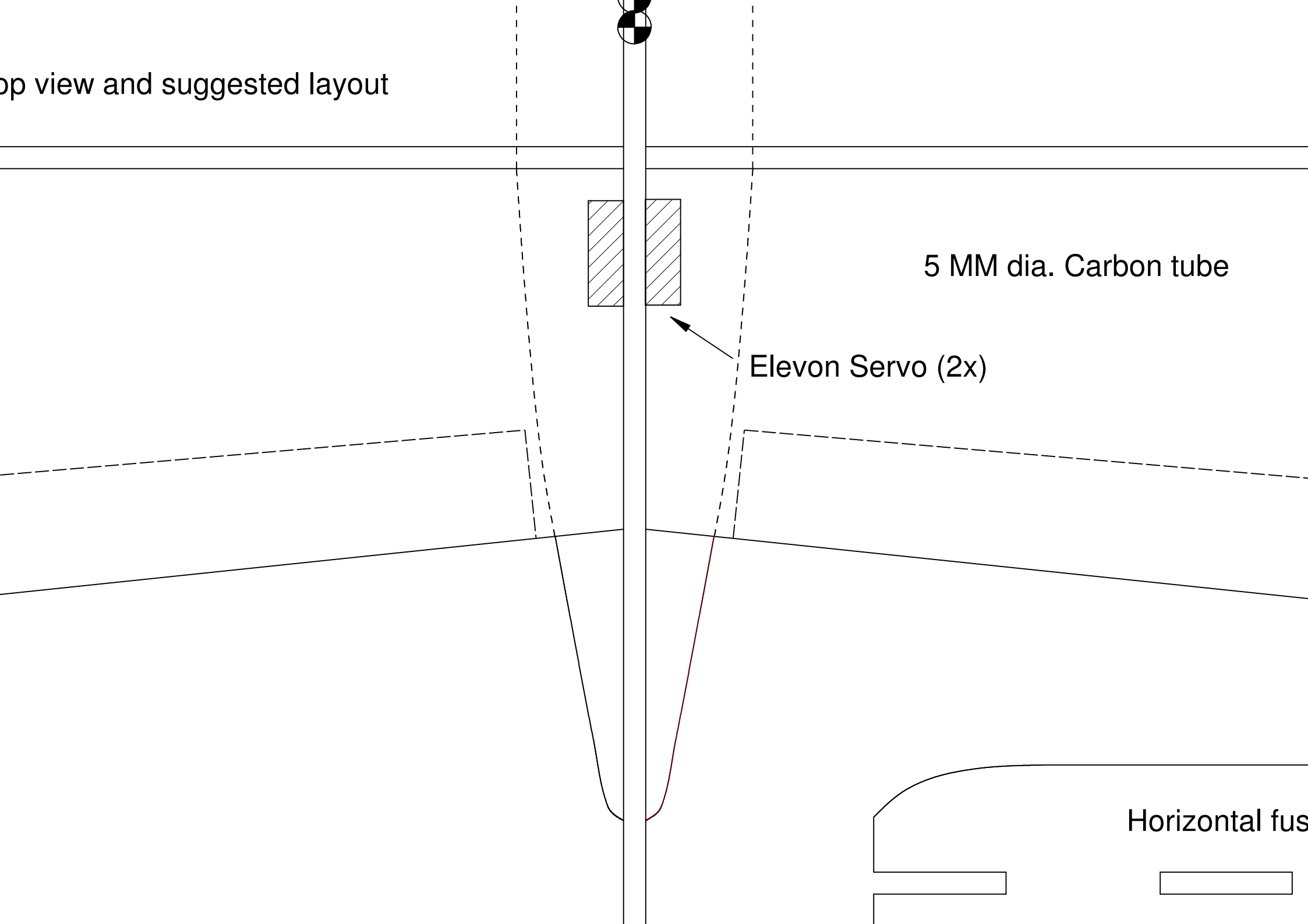

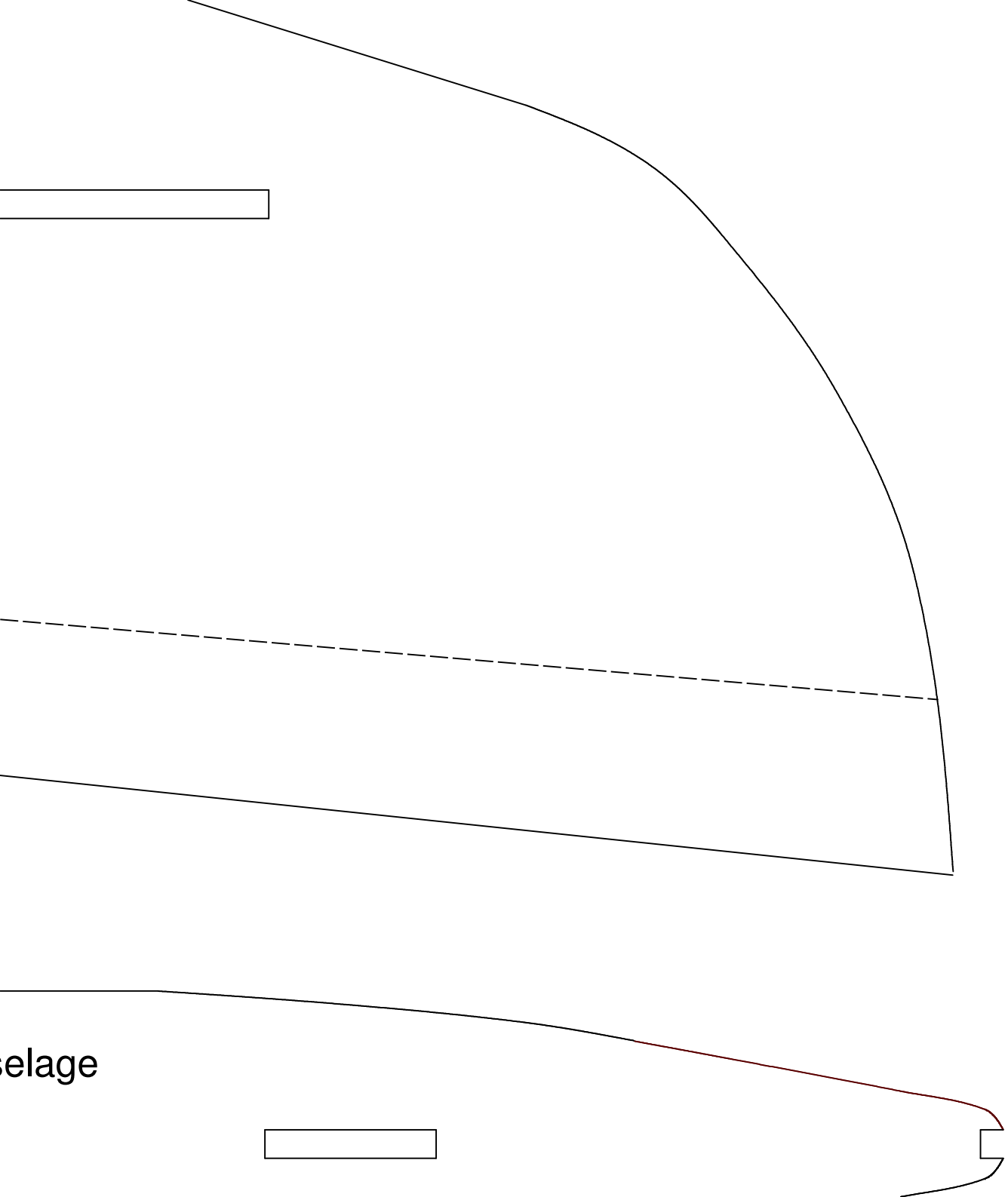

elage

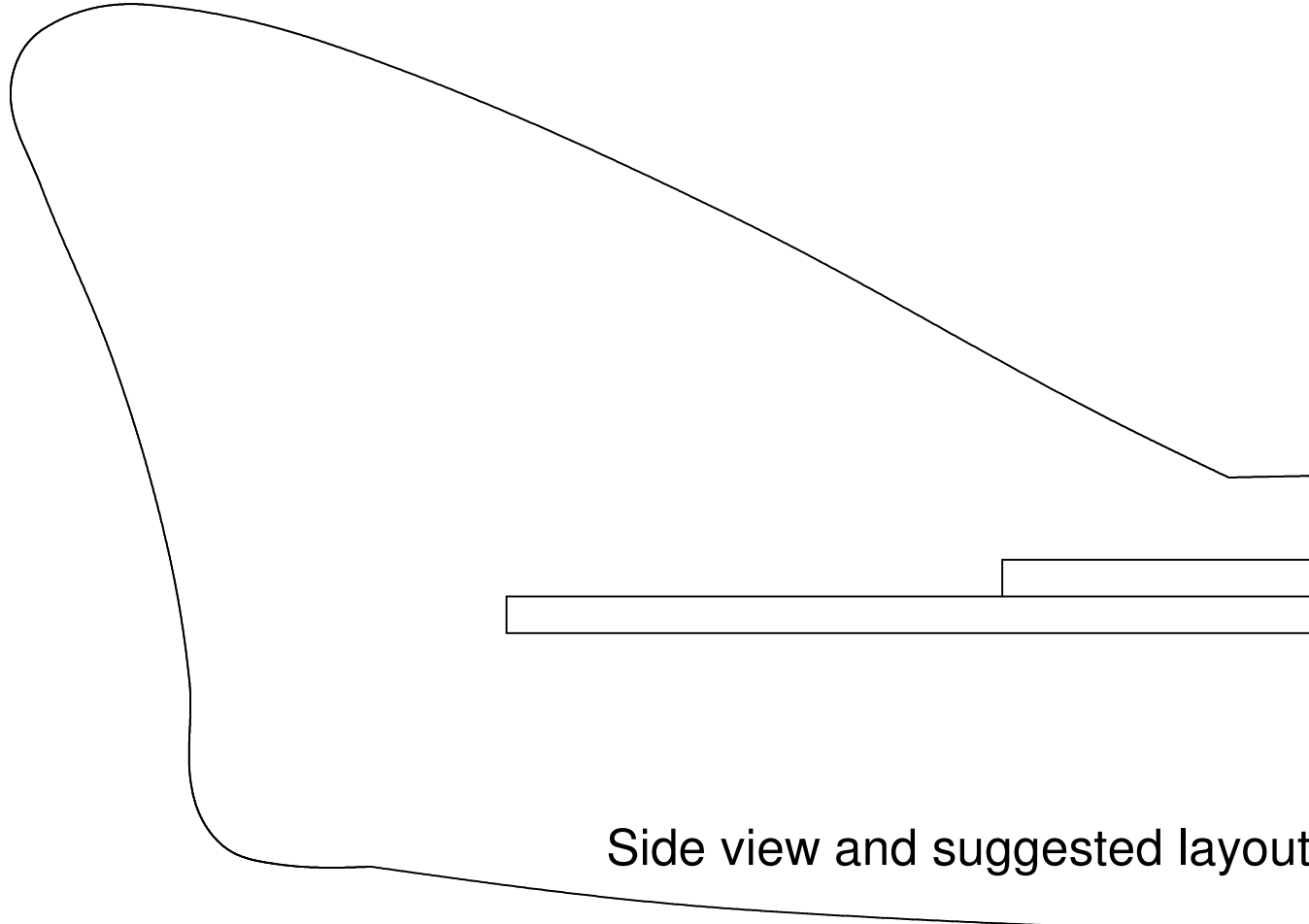

Side view and suggested layout

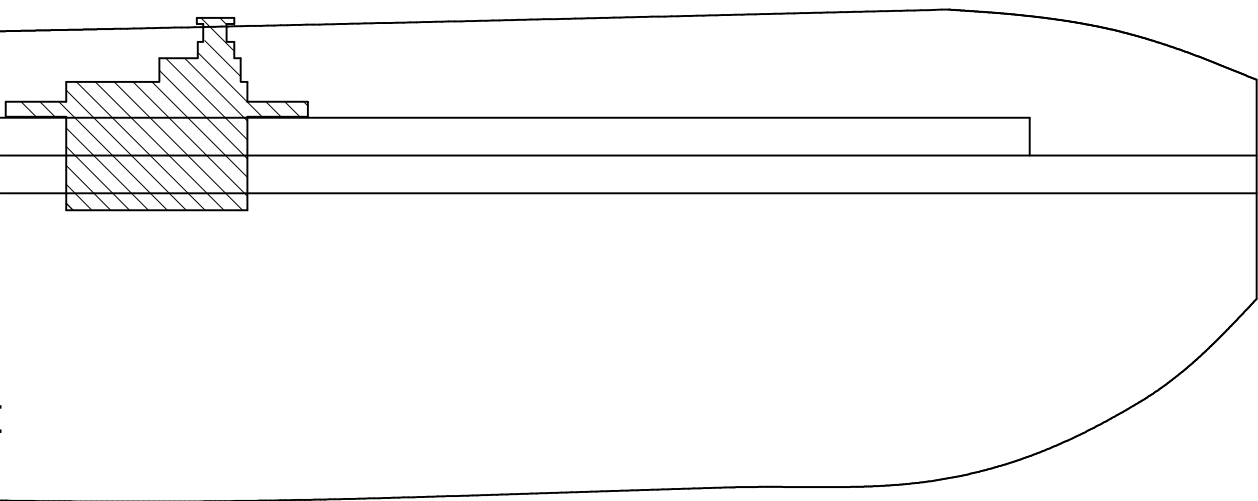

Motor

P
Mat Pow Pro Rec
De De
Cop
RE

Project Depdart 280

Material: 5 mm Depron®

Motor: From CD-Rom motor 14turn 0.4 mm to 150 W brushless

Propeller: Gunther 125 x 110 for CD-Rom motor; propeller to suit larger motors

Recommended RTF Weight: 80 - 200 grams

Design and Drawing: Willem Bravenboer
Depron® 5 MM

Copyright 2008 Willem Bravenboer

VISION V 1.0 2008-10-10